

LED OBSTACLE LIGHTS

POL 10 | POL 32

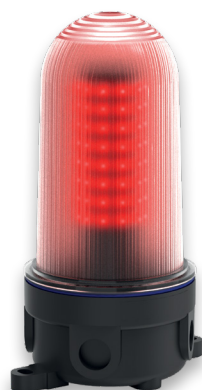

LED obstacle lights, AVV-approved, compliant to ICAO, Annex 14, Volume 1, Chapter 6.

- Omnidirectional light with a radiation angle of 360° for operation at night and at twilight (night identification of aviation obstacles).
- 2 in 1: optional completely redundant construction of LED, electronics and power supply in one housing. A 2nd light is therefore not necessary.
- Automatic switching over to standby light in case of error or by means of external control system.
- Integrated function monitoring with potential-free fault contact.
- Extremely long service life of over 50,000 hrs., hence maintenance-free.
- Optionally equipped with mounting-friendly plug contact.



POL 10

protection
system

operating
temperature

redundant

connector
(option)

PRODUCT		POL 32			POL 10		
DATA							
Rated voltage		115 / 230 V	48 V	12 / 24 V	115 / 230 V	48 V	12 / 24 V
		AC 50 60 Hz	DC	DC	AC 50 60 Hz	DC	DC
Operating range		85–265 V	40–57 V	9.6–28.8 V	85–265 V	40–57 V	9.6–28.8 V
Current consumption, determined arithmetically	115 V	96 mA			60 mA		
	230 V	45 mA			40 mA		
	48 V		270 mA			180 mA	
	24 V			430 mA			350 mA
	12 V			800 mA			600 mA
Fault contact	NC	max. 230 V, 80 mA					
PRODUCT		POL 32-M		POL 10-M	POL 10-M-R	POL 10-M-RA	
Operating mode		continuous light					
Light source		LED array (red)			2x LED array (red)		
Version		monitored		monitored	monitored, redundant		monitored, redundant
Activation of standby light in case of error by means of					external switching		automatic switching
Light intensity (DIN 5037)		32 cd		18 cd			
Beam angle		vertical approx. ±35 °, horizontal 360 °					
Operating temperature		–40 °C ... +55 °C					
Storage temperature		–40 °C ... +70 °C					
Relative humidity		100 %					
Protection system (EN 60529)		IP 68					
Service life of the light source		>50,000 hrs					
Material	lens	 polycarbonate (PC)					
	base	polybutylene terephthalate (PBT)					
Mounting		direct mounting					
Connecting terminal		0.5–1.5 mm² fine wire – H05(07)V-K; 0.5–2.5 mm² single wire – H05(07)V-U					
Weight		approx. 750 g					
Approvals		ICAO		ICAO / AVV		ICAO / AVV	
						ICAO / AVV	

DIMENSIONS

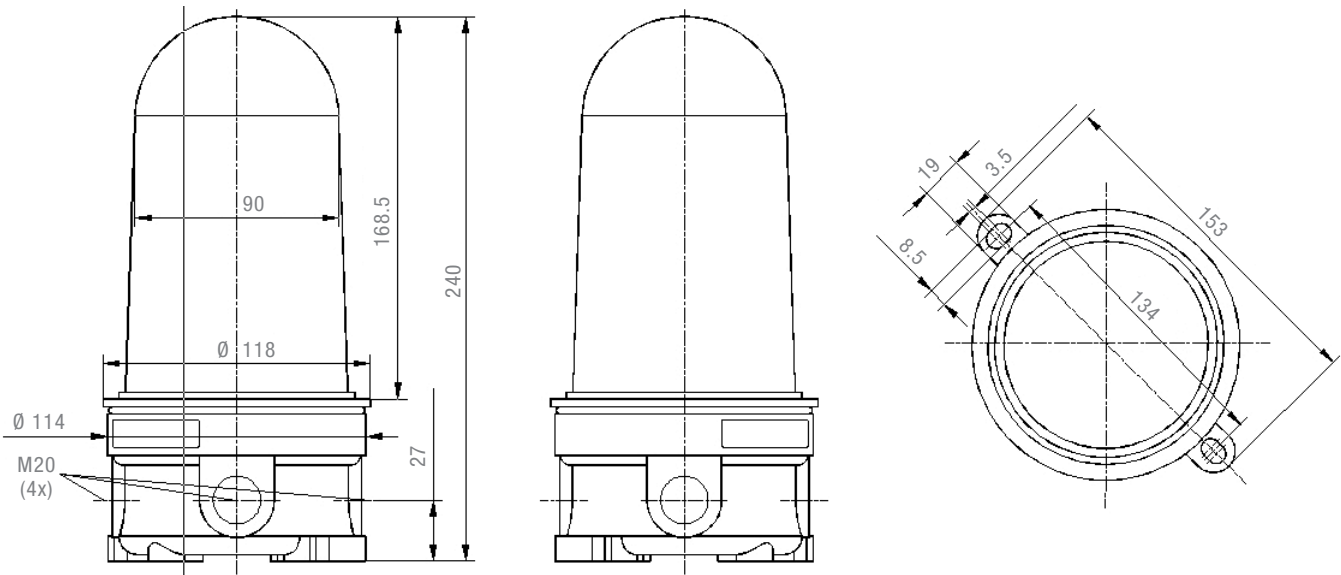

CONNECTION DIAGRAM

POL 32-M

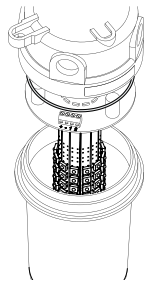

operating voltage
48 V DC

fault contact

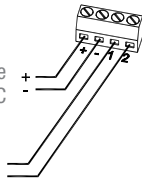

POL 10

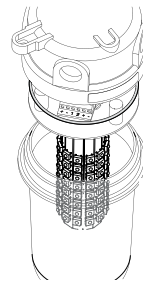

main light
48 V DC

fault contact

standby light
48 V DC

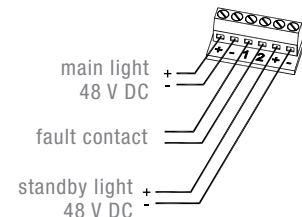

ARTICLE NO.	POL 32-M	POL 10-M	POL 10-M-R	POL 10-M-RA
RATED VOLTAGE				
115 / 230 V AC	21105681005	21105641005	21105641011	21105641010
48 V DC	21105661005	21105651005	21105651011	21105651010
12 / 24 V DC	21105671005	21105631005	21105631011	21105631010

CONFORMITY TO STANDARDS

The lights comply with the requirements of ICAO, Annex 14, Volume 1, Chapter 6. The lights are approved in Germany in accordance with the General Administrative Rules for the Identification of Aircraft Obstructions (AVV).

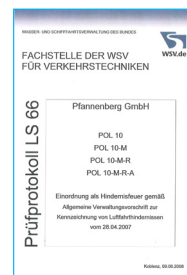

OPTIONS/ACCESSORIES

POWER SUPPLY / BATTERY BACKUP

- Complete solution for uninterrupted power supply of obstruction lights.
- Plug&play solutions with integrated connectors available.
- Several back-up times for all applications and countries.
- Always integrated in a switch cabinet.

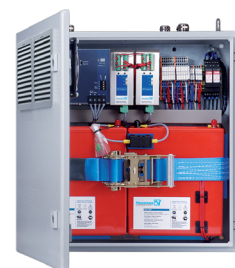

PRODUCT	Night-Tower Plug
ARTICLE NO.	28013000007
Suitable for	POL 10 POL 32