



INDUSTRIAL MARINE BELL

ACOUSTIC

Acoustic Signals Industrial & Marine > IP66 Bells Series

Product overview

The IP66 bell is a fully enclosed signal bell. It is suitable for areas where harsh weather conditions exist, such as exposed outdoor

locations, marine applications and wash/hose down areas. The solenoid driven mechanism produces a clear, loud tone.

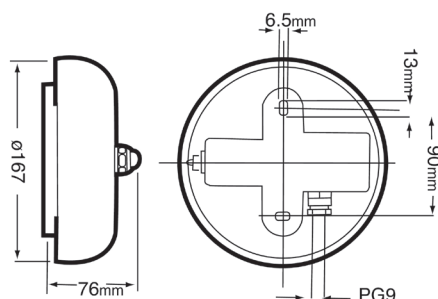

Features

High quality penetrating sound

103 dB

Suitable for harsh weather conditions

IP66

Material

Steel Gong

Code No:	Voltage:	Current:
A6B-12DC-IP66	12v Dc ---	0.60 A
A6B-24DC-IP66	24v Dc ---	0.30 A
A6B-115AC-IP66	115v Ac ~	0.11 A
A6B-230AC-IP66	230v Ac ~	0.05 A



Kg 1.0

°C -30+50

IP 66

dB 103

CONTINUOUS

INDUSTRIAL

APPROVED AND
CONFORMITIES



MARINE